

SOLAR PANEL



SP190W-18V MONO & POLYCRYSTALLINE

Key features:



PID Free Module:
Anti-PID cell and encapsulation technology
Frameless module requires no module grounding which may PID



Higher Lifetime Power Yield:
<0.5% annual power degradation
30 year linear power warranty



Saving BOS Cost:
Designed for high voltage systems of up to 1500 VDC, saving BOS cost



Improved Durability and Reliability:
Dual glass reduces micro-cracking, snail trails, corrasions caused by moisture, sand, salt mist, acid, alkali, etc.



Less Maintenance Requirement:
Reduced soiling and snow coverage requires less maintenance and enhances fire safety



Aesthetically Pleasing Design:
white back sheet maximizes module efficiency up to 16.84%(60-poly max. output 275W); Transparent back sheet increases light transmission, ideal for installations requiring light to pass through



Strengthened Mechanical Support:
5400 Pa snow load, 2400 Pa wind load

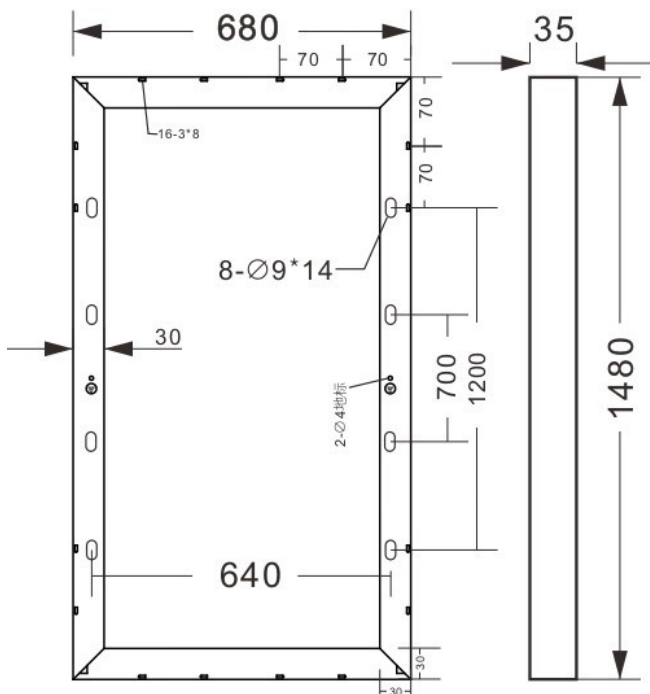
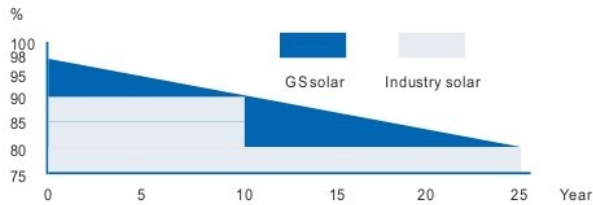
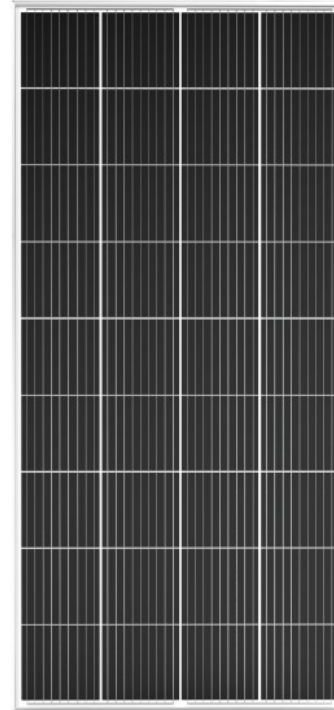

Module Models

Electrical Specifications

Model	SP190W-18V
Peak power(Pmax)	190W
Cell Efficiency	20%
Max. power volt.(Vmp)	18.8V
Max. power current(Imp)	10.11A
Open circuit volt.(Voc)	23.5V
Short circuit current(Isc)	10.23A
Power Tolerance	±3%
Max. system voltage	1000V
Series fuse rating(A)	15
Number of bypass diode	2
Operating temperature	-40°C to +85°C
Maximum system voltage	1000V DC

STC: Irradiance 1000W/m², Module temperature 25°C, AM=1.5

Mechanical Characteristics

Dimensions	1480*680*35mm
Weight	11.7KG
Solar Cells	36 cell in series
Cable	Copper (2.5mm ²)
lengths	700mm (-) and 700mm(+)
Connector	Mc4 Plug Typs
Glass type	High transmits, Low Iron, 3.2mm Tempered Glass
Frame	Aluminium-alloy